



71 South 215 West—Rupert, ID 83350—(208) 436-1770 Fax: (208) 436-1776

## NORWEST DIGGER BLADES

(BLADES ARE MADE FROM T1 MATERIAL)

PART NUMBER	DESCRIPTION	APPLICATION
D200-426LC	L. H. DIGGER BLADE W/CHROME	LOGAN WINDROWER
D200-426LP	L. H. DIGGER BLADE PLAIN	LOGAN WINDROWER
D200-427RC	R. H. DIGGER BLADE W/CHROME	LOGAN WINDROWER
D200-427RP	R. H. DIGGER BLADE PLAIN	LOGAN WINDROWER
D202-472	CENTER DIGGER BLADE	CAMCO
D202-474	CENTER POINT BLADE	CAMCO
D202-475	CENTER DIGGER BLADE	CAMCO
D205-174LC	L. H. DIGGER BLADE W/CHROME	LOGAN HARVESTER
D205-174LP	L. H. DIGGER BLADE PLAIN	LOGAN HARVESTER
D205-175RC	R. H. DIGGER BLADE W/CHROME	LOGAN HARVESTER
D205-175RP	R. H. DIGGER BLADE PLAIN	LOGAN HARVESTER
D210-023ROP	R. H. NARROW OUTER SAND BLADE	SPUDNIK 6400 HARVESTER
D210-024RIP	R. H. NARROW INNER SAND BLADE	SPUDNIK 6400 HARVESTER
D258-070P	DIGGER BLADE PLAIN	ARTSWAY
D425-1023L	CENTER DIGGER BLADE PLAIN	BRACO
D652-1022	CENTER DIGGER BLADE PLAIN	BRACO
D652-1024R	R. H. 29" DIGGER BLADE PLAIN	BRACO
D652-1025L	L. H. 29" DIGGER BLADE PLAIN	BRACO
D652-1026R	R. H. 30" DIGGER BLADE PLAIN	BRACO
D652-1027L	L. H. 30" DIGGER BLADE PLAIN	BRACO
D800-174RC	R. H. SAND BLADE W/CHROME	LOCKWOOD 4500 2 ROW HARVESTER
D800-174RP	R. H. SAND BLADE PLAIN	LOCKWOOD 4500 2 ROW HARVESTER
D800-175LC	L. H. SAND BLADE W/CHROME	LOCKWOOD 4500 2 ROW HARVESTER
D800-175LP	L. H. SAND BLADE PLAIN	LOCKWOOD 4500 2 ROW HARVESTER
D800-196P	CENTER BLADE PLAIN	LOCKWOOD 4500 HARVESTER



71 South 215 West—Rupert, ID 83350—(208) 436-1770 Fax: (208) 436-1776

## NORWEST DIGGER BLADES

(BLADES ARE MADE FROM T1 MATERIAL)

PART NUMBER	DESCRIPTION	APPLICATION
D800-196P3	CENTER BLADE PLAIN 15-1/2" LENGTH W/SLOT	LOCKWOOD 4500 HARVESTER
D800-196P4	CENTER BLADE PLAIN 14" LENGTH W/SLOT	LOCKWOOD 4500 HARVESTER
D800-237C	CENTER BLADE W/CHROME 11-1/2" LENGTH W/SLOT	LOCKWOOD 4 ROW
D800-237P	CENTER BLADE PLAIN 11-1/2" LENGTH W/SLOT	LOCKWOOD 4 ROW
D800-237P2	CENTER BLADE PLAIN 13-1/2" LENGTH W/SLOT	LOCKWOOD 4 ROW
D800-253RP	R. H. INNER SAND BLADE PLAIN	LOCKWOOD 9000 (1990 & OLDER MODELS)
D800-254RP	R. H. OUTER SAND BLADE PLAIN	LOCKWOOD 9000 (1990 & OLDER MODELS)
D800-255LP	L. H. INNER SAND BLADE PLAIN	LOCKWOOD 9000 (1990 & OLDER MODELS)
D800-256LC	L. H. OUTER SAND BLADE W/CHROME	LOCKWOOD 9000 (1990 & OLDER MODELS)
D800-256LP	L. H. OUTER SAND BLADE PLAIN	LOCKWOOD 9000 (1990 & OLDER MODELS)
D800-292RP	R. H. OUTER WIDE SAND BLADE PLAIN	LOCKWOOD 4000W
D800-293LC	L. H. OUTER NARROW SAND BLADE W/CHROME	LOCKWOOD 4000W
D800-293LP	L. H. OUTER NARROW SAND BLADE PLAIN	LOCKWOOD 4000W
D800-294C	CENTER SAND BLADE W/CHROME	LOCKWOOD 4000W
D800-294P	CENTER SAND BLADE PLAIN	LOCKWOOD 4000W
D800-295LP	L. H. OUTER WIDE SAND BLADE PLAIN	LOCKWOOD 4000W
D800-299RP	R. H. OUTER NARROW SAND BLADE PLAIN	LOCKWOOD 4000W
D800-320	DIGGER BLADE W/SEMI NARROW NOSE PLAIN	LOCKWOOD 4640 & 4740
D800-320C	DIGGER BLADE W/SEMI NARROW NOSE & CHROME	LOCKWOOD 4640 & 4740

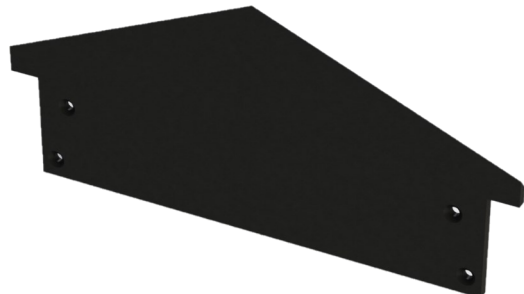
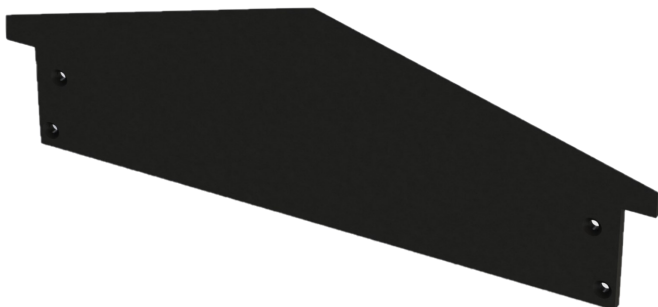



# NORWEST

**MANUFACTURING EQUIPMENT, LLC**

71 South 215 West—Rupert, ID 83350—(208) 436-1770 Fax: (208) 436-1776

## LOCKWOOD STYLE DIGGER BLADES

### PLAIN AND CHROME #'S

- \*\*D800-174RP / D800-174RC
- \*\*D800-175LP / D800-175LC
- \*\*D800-292RP
- \*\*D800-293LP / D800-293LC
- \*\*D800-294P / D800-294C
- \*\*D800-295LP
- \*\*D800-299RP
- \*\*D800-253RP
- \*\*D800-254RP
- \*\*D800-255LP
- \*\*D800-256LP / D800-256LC

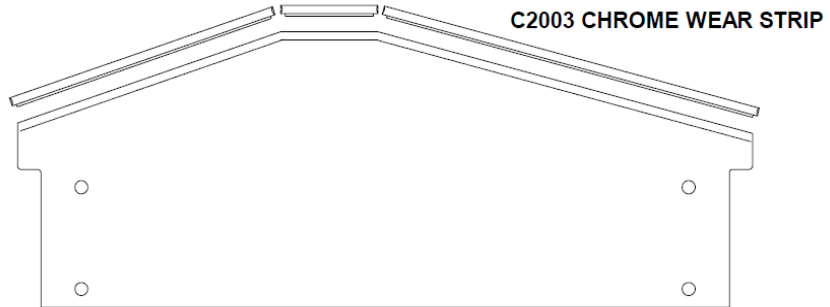

C2003 CHROME WEAR STRIP

\*\*Holes are countersunk to fit 1/2" bolts

\*Semi-pointed Right, Left, Center, Inner & Outer Blades—Beveled 1/2" T1

## CENTER POINT BLADES

- \*\*D800-196P — 11-1/2" STANDARD
- \*\*D800-196P3 — 15 1/2" EXT. W/HOLE
- \*\*D800-196P4 — 14" NO CENTER HOLE CUT
- \*\*D800-237C — 11-1/2" STANDARD W/CHROME
- \*\*D800-237P — 11-1/2" STANDARD
- \*\*D800-237P2 — 13-1/2" EXTENDED W/SLOT

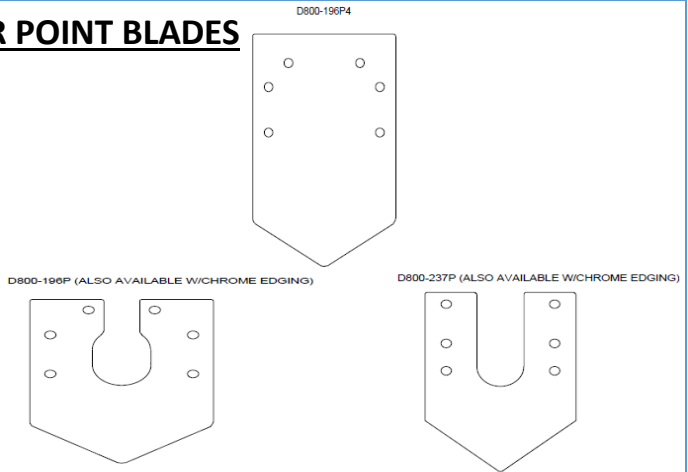

D800-196P4

D800-196P (ALSO AVAILABLE W/CHROME EDGING)

D800-237P (ALSO AVAILABLE W/CHROME EDGING)

## CAMCO STYLE DIGGER BLADES

### PLAIN AND CHROME #'S

- \*\*D202-472 — CENTER POINT
- \*\*D202-474 — CENTER POINT
- \*\*D202-475 — CENTER POINT

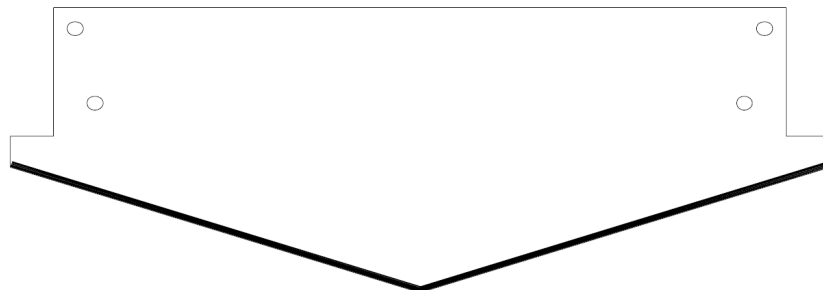

D202-472  
CAMCO SHORT POINT DIGGER BLADE  
1/2" T1 W/BEVEL

MADE FROM 1/2" T1



# NORWEST

**MANUFACTURING EQUIPMENT, LLC**

71 South 215 West—Rupert, ID 83350—(208) 436-1770 Fax: (208) 436-1776

## SPUDNIK STYLE DIGGER BLADES

FOR 6400 HARVESTOR

D210-023RP

- \*\*D210-023ROP — R.H. NARROW OUTER SAND BLADE
- \*\*D210-024RIP — R.H. NARROW INNER SAND BLADE

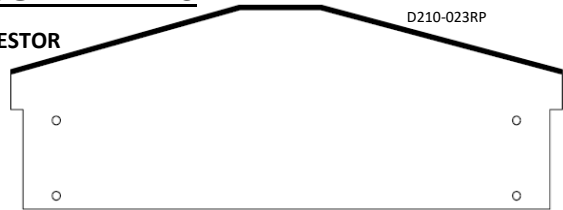

MADE FROM 1/2" T1

## BRACO STYLE DIGGER BLADES

- \*\*D425-1023L—CENTER

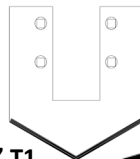

D425-1023L  
3/8" T1 CENTER W/BEVEL  
4-1/2" COUNTERSUNK HOLES

D652-1024  
BRACO R.H. 29"  
BLADE

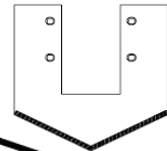

D652-1022  
BRACO CENTER BLADE 3/8" T1  
MOUNTED COUNTERSUNK HOLES.  
COUNTERSUNK SAME SIDE AS BEVEL.

- \*\*D652-1022—CENTER DIGGER 3/8" T1
- \*\*D652-1024R—RIGHT HAND 29" DIGGER
- \*\*D652-1025L—LEFT HAND 29" DIGGER
- \*\*D652-1026R—RIGHT HAND 30" DIGGER
- \*\*D652-1027L—LEFT HAND 30" DIGGER

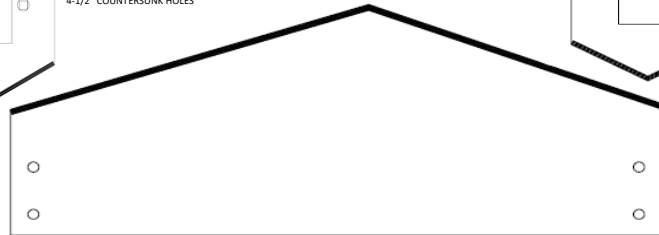

MADE FROM 3/8" T1 & 1/2" T1

## ARTSWAY STYLE DIGGER BLADES

- \*\*D258-070P

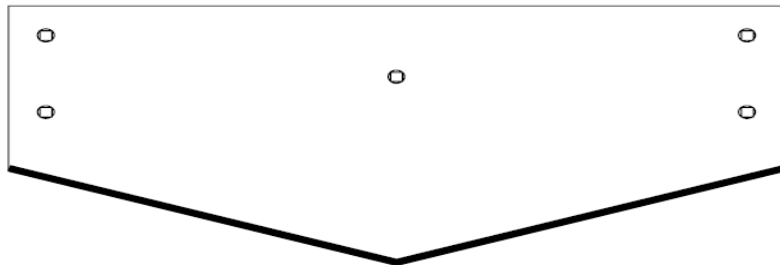

MADE FROM 1/2" T1

## LOGAN STYLE DIGGER BLADES

### PLAIN AND CHROME #'S

- \*\*D200—426LC
- \*\*D200—426LP
- \*\*D200—427RC
- \*\*D200—427RP

- \*\*D205—174LC
- \*\*D205—174LP
- \*\*D205—175RC
- \*\*D205—175RP

D200-427RP  
3/4" T1 W/BEVEL

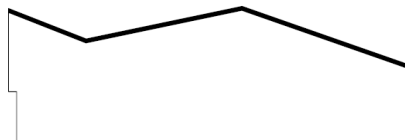

D200-426LP  
3/4" T1 W/BEVEL

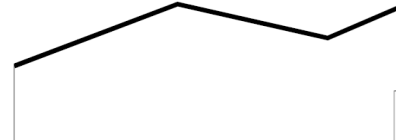

D205-174LP

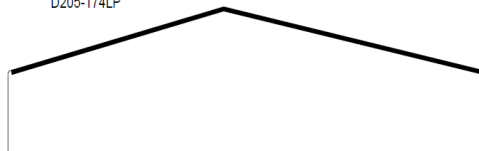



# NORWEST

**MANUFACTURING EQUIPMENT, LLC**

71 South 215 West—Rupert, ID 83350—(208) 436-1770 Fax: (208) 436-1776

## NORWEST PLANTER SHOE

### FURROW OPENER OPTIONS 4, 6, OR 8 ROW

**D800-275—REPLACEMENT SHOE FOR SHOE ASSEMBLY**

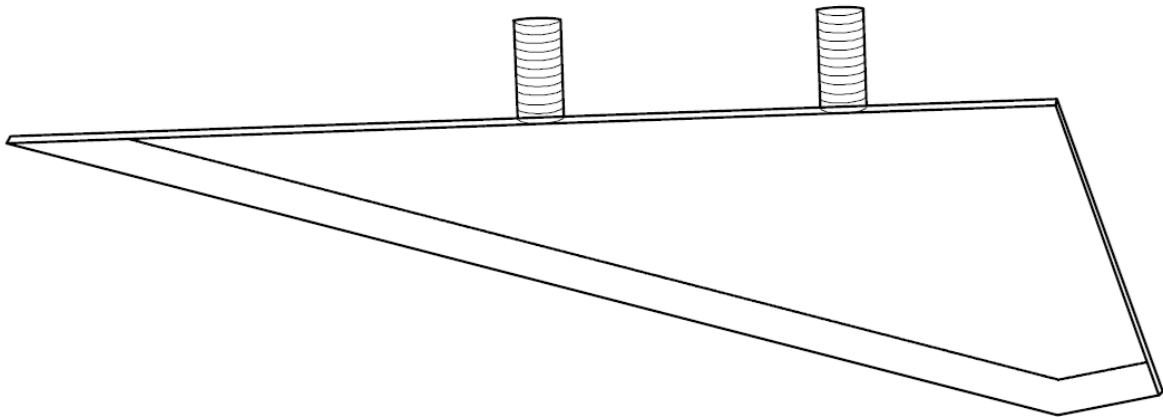

**D800-324—LOCKWOOD SHOE ASSEMBLY**

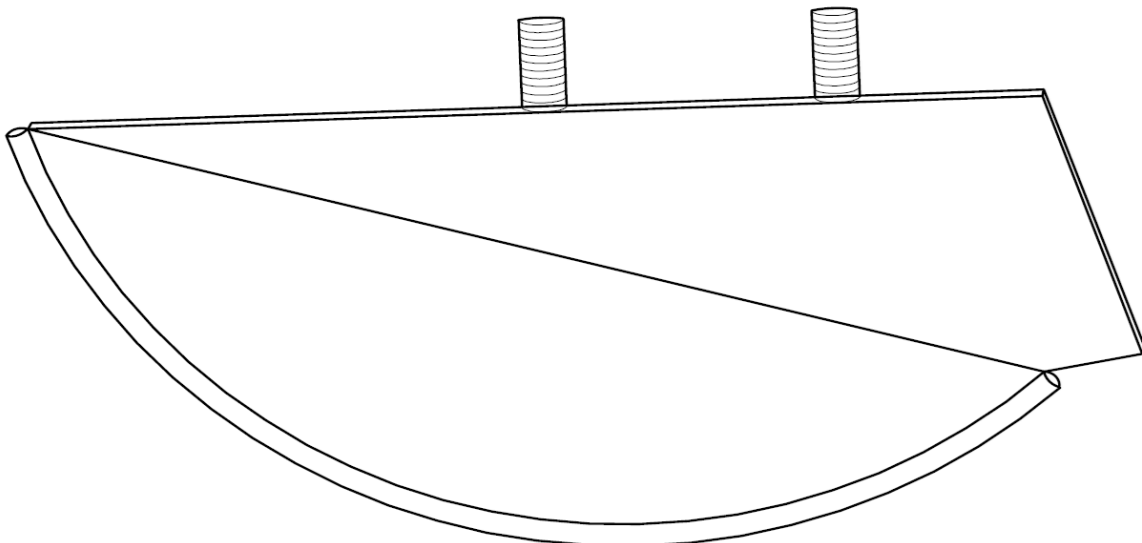

LOCKWOOD #0800-0324-17



# NORWEST

## MANUFACTURING EQUIPMENT, LLC

71 South 215 West—Rupert, ID 83350—(208) 436-1770 Fax: (208) 436-1776

### COVERING DISCS

DSLW804-16	SMOOTH COVERING DISC FOR LOCKWOOD 14" X 4.5MM
DSLW804-56	SMOOTH COVERING DISC FOR LOCKWOOD 16" X 4.5MM
DSNK210098	SMOOTH CONCAVE DISC FOR SPUDNIK 16" X 4.5MM W/4-9/16" HOLES OF A 5" C TO C



### VINE COULTERS FOR HARVESTERS

DSR2460-LW	SMOOTH FLAT COULTER 24" X 6mm W/LOCKWOOD PATTERN
DNR2460-LW	NOTCHED FLAT COULTER 24" X 6mm W/LOCKWOOD PATTERN
DSR2480-LW	SMOOTH FLAT COULTER 24" X 8mm W/LOCKWOOD PATTERN
DSR2480-LWW	SMOOTH WAVY COULTER 24" X 8mm W/LOCKWOOD PATTERN
DSR2810-SP	SMOOTH FLAT COULTER 28" X 10mm W/SPUDNIK PATTERN



\*\*VINE COULTERS FOR HARVESTERS CAN BE CUT TO FIT DAHLMAN, DOUBLE L, HESSTON, LOCKWOOD, LOGAN, AND SPUDNIK. OTHER SIZE COULTERS ALSO AVAILABLE UPON REQUEST.\*\*

### HUB PATTERNS AVAILABLE

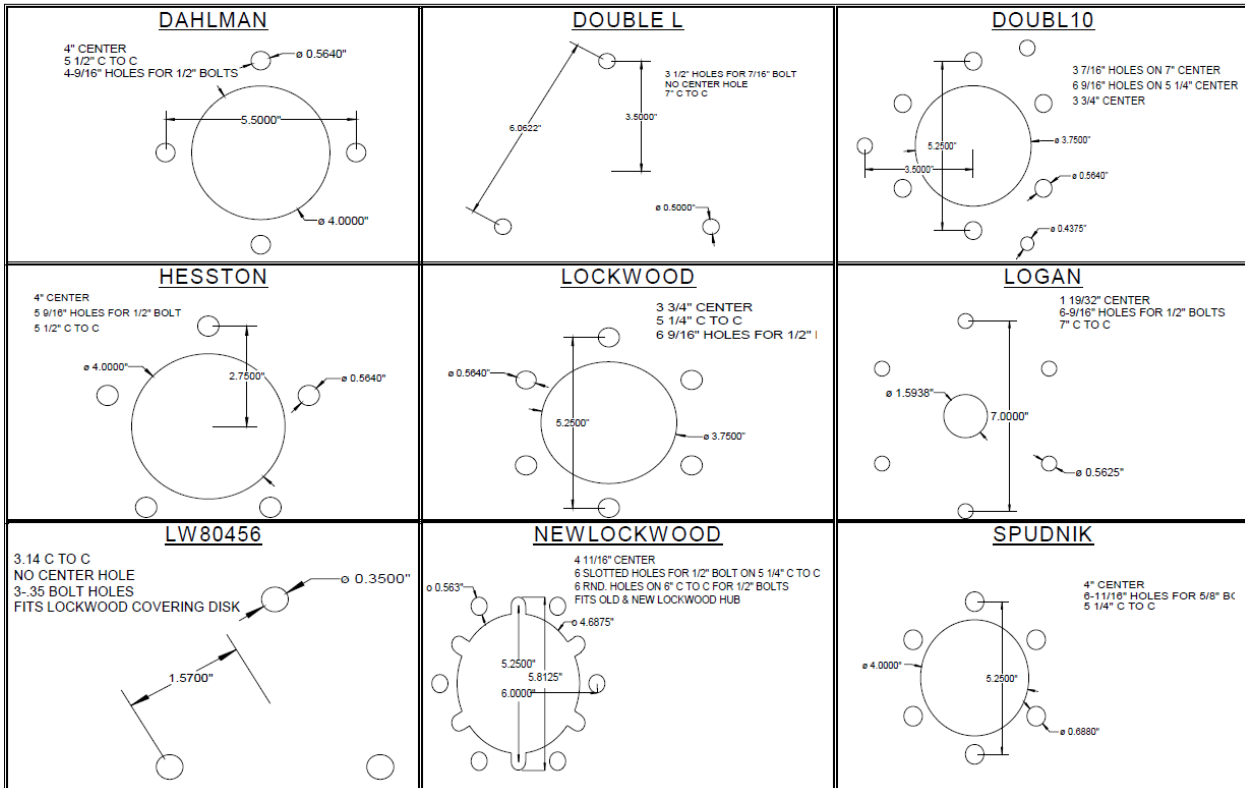



# NORWEST

**MANUFACTURING EQUIPMENT, LLC**

71 South 215 West—Rupert, ID 83350—(208) 436-1770 Fax: (208) 436-1776

**CS4040A- SINGLE SPRING TRIP CLAMP FOR 2-1/4" DIAMOND & BAR ATTACHMENT.**

**CS4040- SINGLE SPRING TRIP CLAMP FOR 4" X 4" THRU 5" X 7" BAR ATTACHMENT.**

REF.	DESCRIPTION	PART NO.	REQ.	REF.	DESCRIPTION	PART NO.	REQ.
1	MOUNTING BODY	CS-35812	1	22	3/4" NYLOK JAM NUT	FJYN34	1
2	SHANK MOUNTING BRACKET	CS-35815	1	23	1/2" x 2" HEX BOLT	FHB12200G5	2
3	SPRING BRACKET	CS-35813	1	24	HEX NUT 1/2"	FHN12	2
4	SPRING	16-35814	1	25	LOCK WASHER 1/2"	FLW12	2
5	TENSION ROD	CS-35817	1	26	1/2" x 2 1/2" HEX BOLT G5	FHB12250G5	1
6	STRAP	CS40S	1	27	1/2" NYLOK NUT	FYHN12	1
7	STRAP	CS40SH	1	28	7/8" X 7" HEX BOLT G5	FHB78700G5	2
20	7/8" NYLOK NUT	FYHN78	1	29	7/8" HEX NUT	FHN78	2
21	3/4" x 5 1/2" HEX BOLT G5	FHB34550G5	1	30	SHANK	16-35811	1

CS4040A USES N1 DROP FORGED BAR CAPS FOR 2-1/4" DIAMOND BAR ATTACHMENT.  
 SPRING HAS 502 lbs OF TORQUE PER SQUARE INCH.

**CS4040**



**CS4040 EXPLODED VIEW**

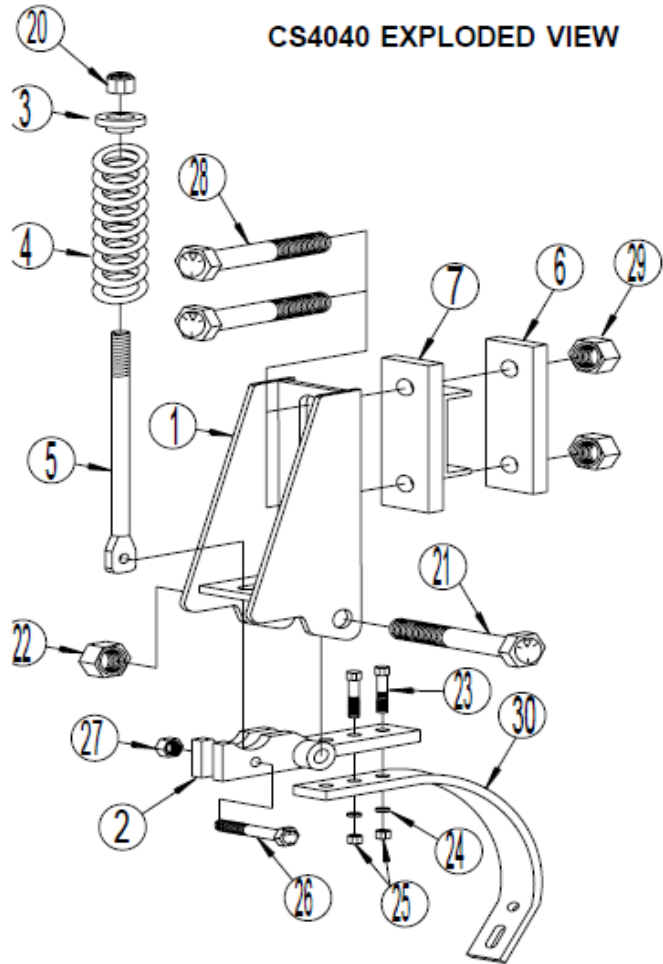

**\*\*COMMONLY USED ON POTATO PLANTERS SPECIFICALLY DOUBLE L\*\***

# Hilling Wing Assembly

- Available in 2 sizes
- Fits most diker style machines
- Commonly used for Potato applications, but will work for other row crops
- Wings easily adjustable for hill size preferences. (Widths from 16" to 28")



**Norwest Part #**

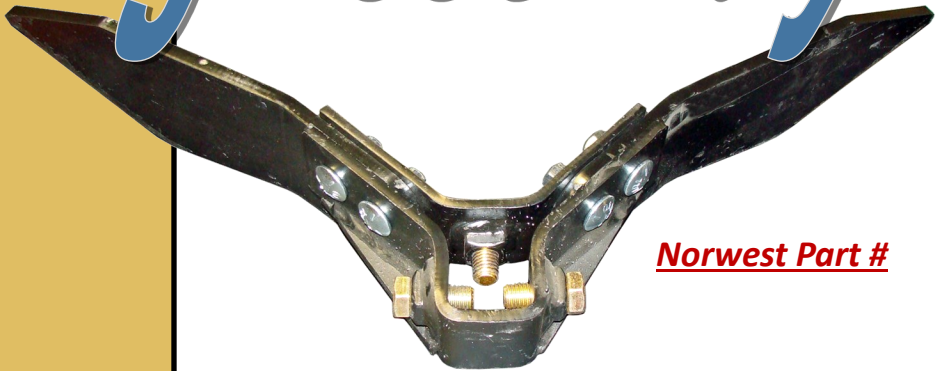

**Norwest Part #**

## Hilling Wing Assembly Sub Parts for *B-2800 & B-2800L*

PART	NORWEST PART NUMBER	DESCRIPTION
	Z-B-2830	Right Hand Wing for B-2800 & B-2800L Hilling Wing Assemblies
	Z-B-2831	Left Hand Wing for B-2800 & B-2800L Hilling Wing Assemblies
<b>For B-2800 Assembly Only</b>		
	Z-B-2810	Front Strap
	Z-B-2840	Rear Strap
<b>For B-2800L Assembly Only</b>		
	Z-B-2810L	Front Strap
	Z-B-2840L	Rear Strap

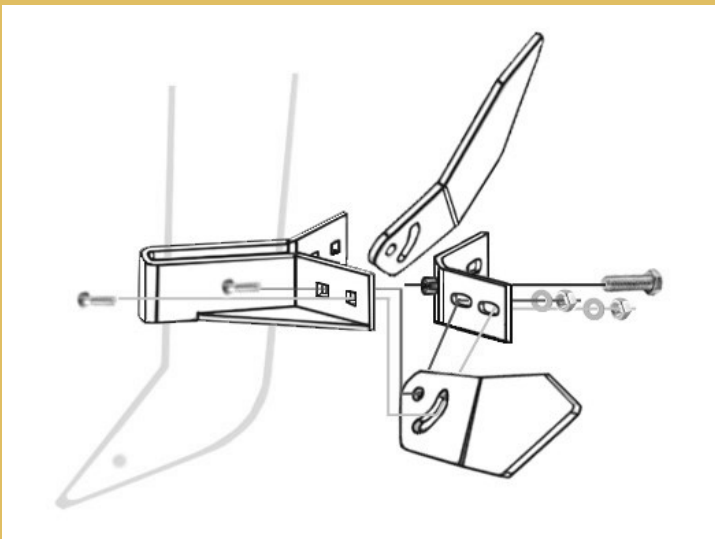

71 South 215 West • Rupert, Idaho 83350  
Phone: (208)436-1770 • Fax: (208)436-1776



# Hilling Disc Assemblies



HILLING DISC ASSEMBLIES	
NORWEST PART NUMBER	BLADE SIZE
G30-S10	10" x 3.0 mm Concave
G30-S12	12" x 3.0 mm Concave
G30-S14	14" x 3.5 mm Concave
G30-S16	16" x 3.5 mm Concave
G30-S18	18" x 4.5 mm Concave
G30-S20	20" x 4.5 mm Concave



- ◆ Available in multiple blade sizes from 10" to 20"
- ◆ Features a triple lip seal for extra protection
- ◆ Uses Norwest Double Disc Hub: **E30-16NHUB**
  - ◇ 4-1/4" C to C; 2-15/16" Center Hole
  - ◇ (4) 13/32" Square Holes for 3/8" Carriage Bolts
- ◆ 1-3/8" Round Shank
  - ◇ 24-1/4" Length
- ◆ Mounts with Norwest Clamp: **5820**
  - ◇ Tool bar clamp for 2-1/4" Diamond Bar
  - ◇ Fits 1-3/8" to 1-1/2" ROUND SHANK



**NORWEST**  
M A N U F A C T U R I N G



Reference Number	Description	Norwest Part Number	Required Pcs.
①	1-3/8" x 24-1/4" Straight Round Hiller Shank with 3/4" Hole	Z-2183-3153427	1
②	Norwest Disc Spindle with Grease Hole; 90°	E30-16NSP	1
③	Triple Lip Seal	NW40-3	1
④	Inner/Outer Bearing	L44643	2
⑤	Tapered Bearing Race (Inner/Outer)	L44610/2	2
⑥	Hub Casting Less Races for E30-16NHUB	Z-E30-16NH	1
⑦	Smooth Disc Blade • 10", 12", 14", 16", 18" or 20"	Multiple Part #'s	1
⑧	3/8" x 1" Carriage Bolt. Grade 5	FCB38100G5	2
⑨	Flat Washer for E30 Spindle	913608	1
⑩	Castle Nut	912954	1
⑪	Cotter Pin	905936	1
⑫	Dust Cap	909905	1
⑬	Dust Cover Strap	E30-16N STRAP	1
⑭	3/8" x 1-1/4" Carriage Bolt. Grade 5 (for use with the Dust Cover Strap)	FCB38125G5	2
⑮	3/8" Flat Washer (for use with the Dust Cover Strap)	FFW38	2
⑯	3/8" Lock Washer	FLW38	4
⑰	3/8" Hex Nut	FHN38	4

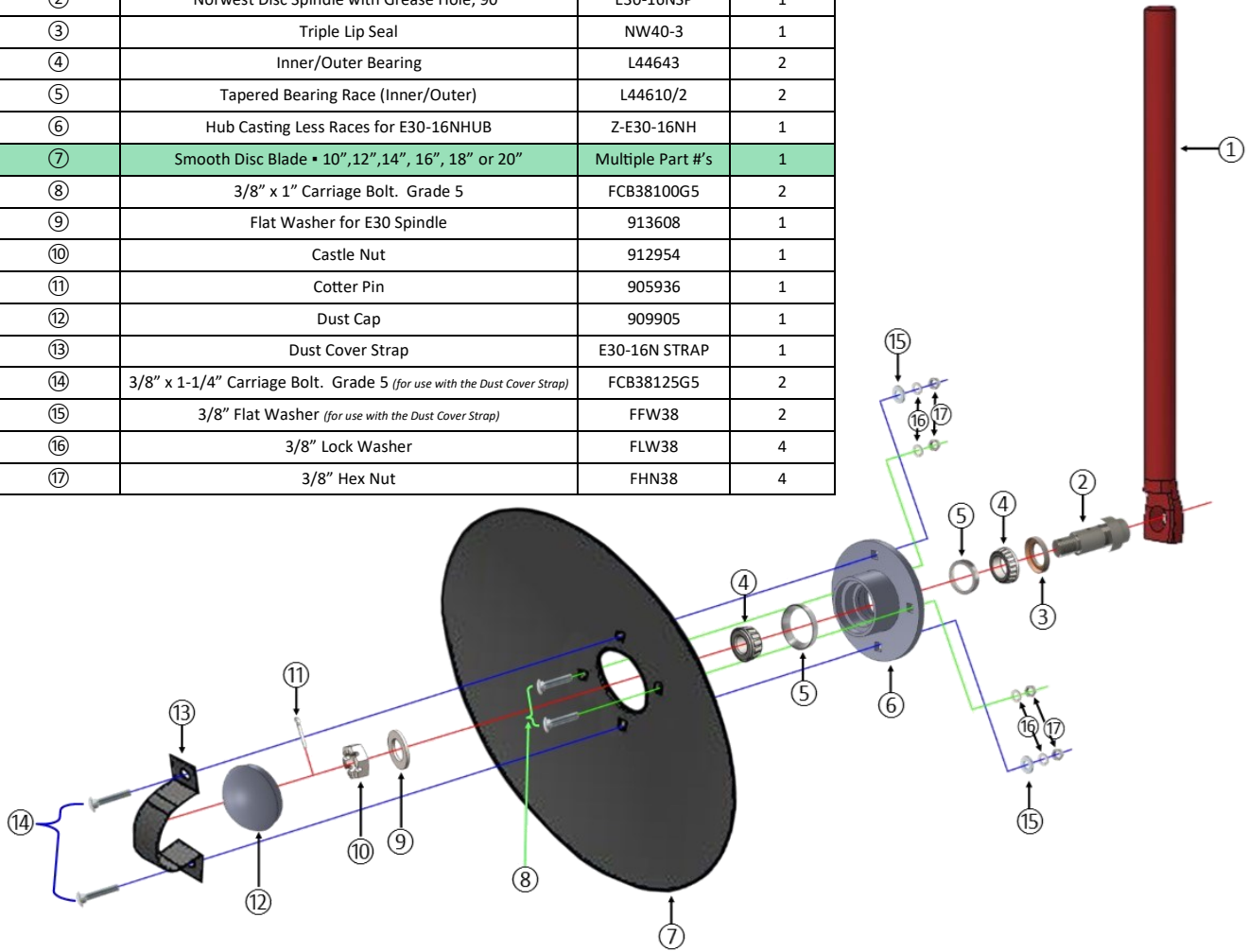

# Hilling Disc Assembly

## HILLING DISC ASSEMBLIES

### NORWEST PART NUMBER

### BLADE SIZE

G30-S10	10" x 3.0 mm Concave
G30-S12	12" x 3.0 mm Concave
G30-S14	14" x 3.5 mm Concave
G30-S16	16" x 3.5 mm Concave
G30-S18	18" x 4.5 mm Concave
G30-S20	20" x 4.5 mm Concave

### Norwest Part #

### G30-100-H

- 1-3/8" Straight round hiller shank with 3/4" hole
- Disc Spindle



Reference Number	Description	Norwest Part Number	Required Pcs.
①	1-3/8" x 24-1/4" Straight Round Hiller Shank with 3/4" Hole	Z-2183-3153427	1
②	Norwest Disc Spindle with Grease Hole; 90°	E30-16NSP	1
③	Triple Lip Seal	NW40-3	1
④	Inner/Outer Bearing	L44643	2
⑤	Tapered Bearing Race (Inner/Outer)	L44610/2	2
⑥	Hub Casting Less Races for E30-16NHUB	Z-E30-16NH	1
⑦	Smooth Disc Blade • 10", 12", 14", 16", 18" or 20"	Multiple Part #'s	1
⑧	3/8" x 1" Carriage Bolt. Grade 5	FCB38100G5	2
⑨	Flat Washer for E30 Spindle	913608	1
⑩	Castle Nut	912954	1
⑪	Cotter Pin	905936	1
⑫	Dust Cap	909905	1
⑬	Dust Cover Strap	E30-16N STRAP	1
⑭	3/8" x 1-1/4" Carriage Bolt. Grade 5 (for use with the Dust Cover Strap)	FCB38125G5	2
⑮	3/8" Flat Washer (for use with the Dust Cover Strap)	FFW38	2
⑯	3/8" Lock Washer	FLW38	4
⑰	3/8" Hex Nut	FHN38	4

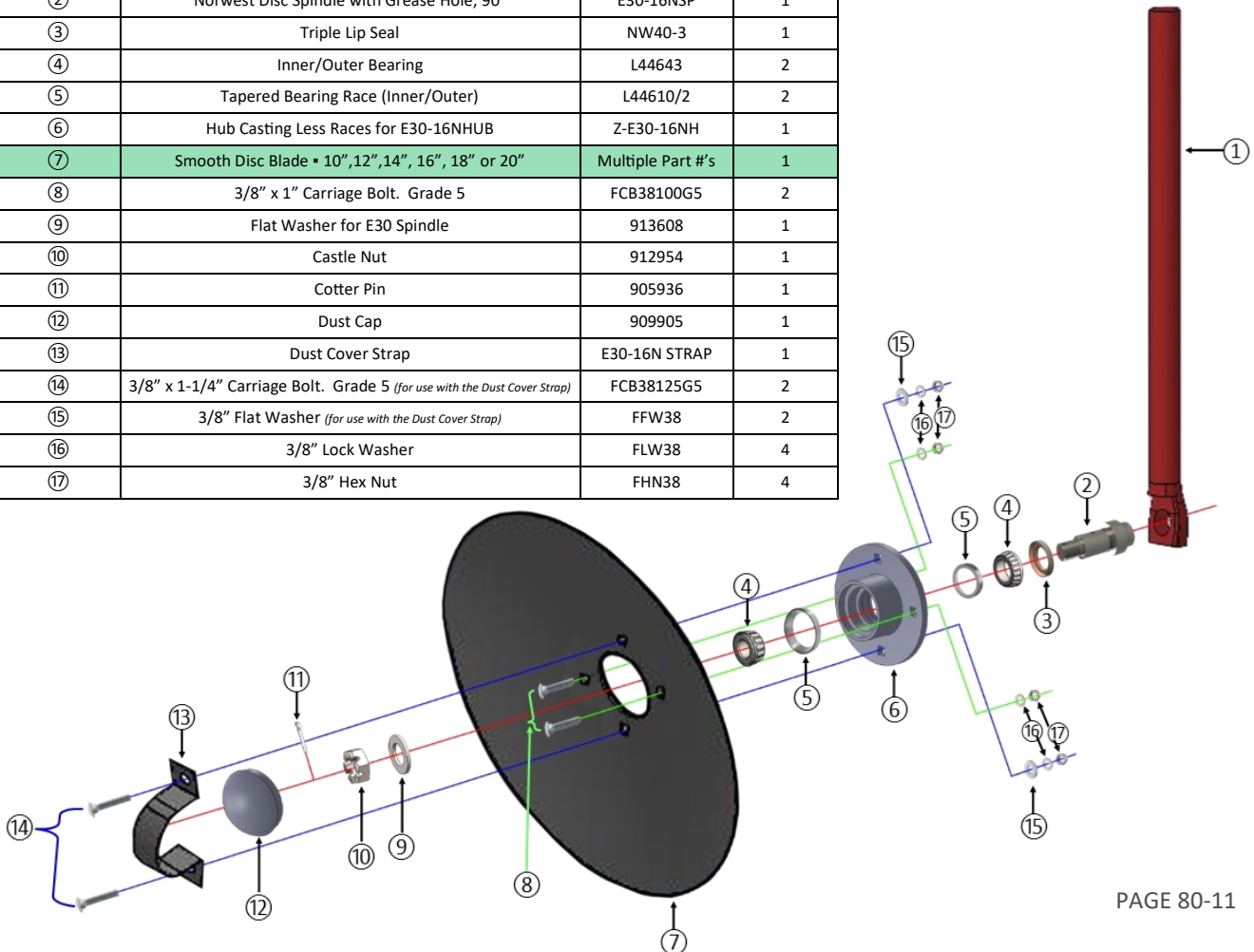



Norwest Part #

**DSR0820-26**

*8" x 2.5mm Seed Cutter Blade  
with 26mm Round Center Hole*

Norwest Part #

**DSR1420-32**

*14" x 3.0mm Seed Cutter Blade  
with 32mm Round Center Hole*

**. For POTATO SEED CUTTING MACHINES**

**. LIMITED STOCK AVAILABLE**

**. CALL FOR PRICING & AVAILABILITY**

**(208) 436-1770**



**NORWEST**

M A N U F A C T U R I N G



71 South 215 West • Rupert, ID 83350 • Phone: (208)436-1770 • Fax: (208)436-1776

[www.norwest-mfg.com](http://www.norwest-mfg.com)



# NORWEST

MANUFACTURING

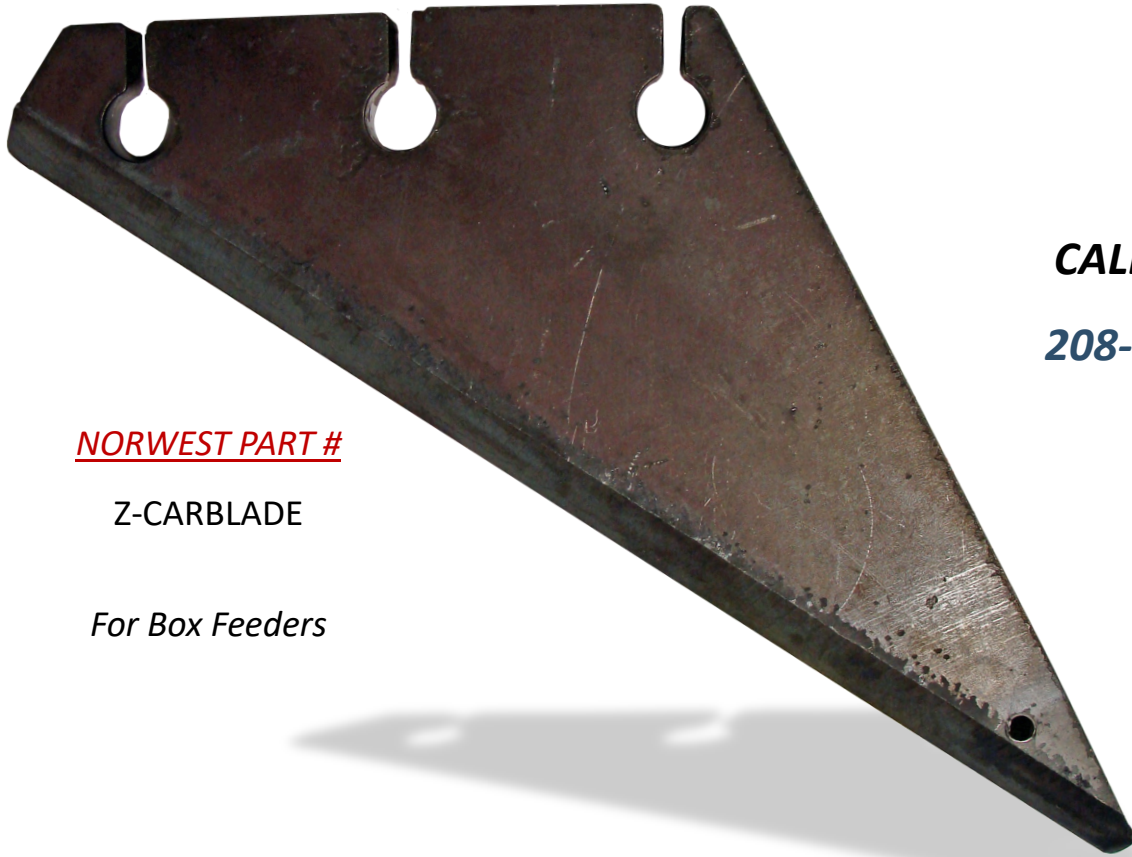

**CALL TODAY!**  
**208-436-1770**

NORWEST PART #

Z-CARBLADE

*For Box Feeders*

